

STEAMMAX™ CLEANER

Top Innovations, Inc.
Innovative Products to Make Your Life Easier

SteamMax™ Cleaner Model SF-275 Owner's Manual



- Steam Clean and Mop Hard-Surface Floors
- Melt Away Grease, Grime, and So Much More!

Top Innovations, Inc.
400 NW Platte Valley Drive, Riverside, MO 64150
1-800-711-6617 Tel: 816-584-9700 Fax: 816-584-9066
www.topinnovations.com

Index

Welcome to the World of Steam	3
Important Safety Guidelines	4-6
Product Specifications	6
Product Information	7
Using Your SF-275 Steam Max Cleaner	7-11
Care and Storage	12
Problem Solving	13-14
Helpful Cleaning Tips	15-16
Limited Warranty	17
Parts Reorder Form.	18

STEAMMAXTM CLEANER

Welcome to the World of Steam!

Dear Valued Customer:

Thank you for purchasing your SF-275 SteamMax Cleaner from our rapidly growing Steam Fast line. Our firm takes pride in providing you with quality, value, and excellent service.

The SF-275 SteamMax Cleaner solves a variety of cleaning tasks, including the elimination of unpleasant odors in all areas of your home. Removal of soap scum, mold, mildew, grease, grime, and calcium deposits in kitchens and bathrooms is quick and easy. Blinds, windows, and vents can be cleaned with a burst of steam from the steam jet nozzle. Easily clean and sanitize appliances, counter tops, floors, and children's toys. Your SteamMax Cleaner can also be used to address a variety of cleaning problems outside the home. Tackle tough jobs such as messy barbecue grills, cars, motorcycles, trash cans, and patio furniture. We are sure that you will discover a multitude of ways in which you can utilize steam to make your life easier.

Top Innovations, Inc. would like to invite you to take advantage of our customer support web site at www.topinnovations.com. There you will find additional information about the many other exciting Steam Fast products that are available, helpful tips on ways in which you can utilize your SF-275 SteamMax Cleaner and other useful information to assist you in maximizing the power of steam!



Benny Lee

Chairman and CEO, Top Innovations, Inc.





IMPORTANT SAFETY GUIDELINES

Basic safety precautions should be used when using any electrical appliance.

In order to reduce the risk of fire, electric shock, or other injuries, please read all of the following instructions before using your SF-275 SteamMax Cleaner.

1. Do not leave your SF-275 Steam-Max Cleaner unattended when plugged in or not in use.
2.  **This unit is not a toy. Close supervision is required when using the unit near children, pets, and plants. The steam produced by the unit is hot and pressurized. Care must be taken to avoid burns or other injuries. Never point the nozzle at pets or people.**
3. Always unplug the electrical cord when the unit is not in use. Do not use this unit if the electrical cord or outlet is damaged. Do not use the unit if it is not working properly or has been dropped, damaged, or left outdoors. If such damage occurs, return the unit to an approved service technician for repair.
4. This unit is an electrical appliance. Do not submerge it in water. Do not use the steam hose or electrical cord as a handle. Do not allow the cord to be crimped in doors or by allowing the unit to roll over it. Do not pull or stretch the cord around sharp corners or edges. Be sure to keep the electrical cord away from all heated surfaces.
5. Do not use this unit with electrical cords or outlets that have inadequate current capacity. A three-prong outlet or a properly grounded adapter is necessary when using the SF-275 SteamMax Cleaner.
6. In order to unplug the SF-275 SteamMax Cleaner, grasp the plug and pull smoothly and firmly from the outlet. Do not attempt to unplug the unit by pulling or tugging on the cord.

SAVE THESE INSTRUCTIONS!

7.  Do not handle or use this unit while hands are wet or when not wearing shoes. To avoid falls and other injuries, be sure to dry any wet areas on floors and to stand away from damp surfaces while using the SteamMax Cleaner.
8. The SF-275 SteamMax Cleaner is only meant to be used with recommended SF-275 accessories. Other types of attachments such as those used with vacuum cleaners are not to be used with the SteamMax Cleaner. Doing so may cause injuries or damage to the unit.
9. Nozzles and attachments become hot during use. To avoid injuries, do not touch nozzles while using this appliance. Do not attempt to change attachments while the steam control button is depressed.
10.  Do not turn the unit on its side when in use.
11. Always use the provided measuring cup when filling your SteamMax Cleaner. Do not overfill the water reservoir.
12. Do not steam tinted (filmed) glasses directly since the hot steam may damage the soft plastic film.
13.  Before filling the unit, take the following steps: (1) Turn appliance off. (2) Unplug electrical cord. (3) If the unit has been in use, relieve pressure by pressing the steam-control button. (4) Untwist cap slowly while continuing to press down on steam control button. (5) Caution: Allow unit to cool down for 5 minutes before refilling the unit.
14. Only water should be used in the unit. Other cleaning agents will damage the unit and can cause injuries.
15. Do not operate the unit if the steam opening is blocked. Should this occur, shut the unit off and unplug.
16. Store your SF-275 SteamMax Cleaner in a cool, dry place. Allow the unit to cool completely and empty before storage.

SAVE THESE INSTRUCTIONS!

**Use Caution When Cleaning
Certain Types of Surface Areas**

1. Use the cloth-cover attachment on sealed floor surfaces to create a shine. Do not use on unsealed wood products and surfaces.
2. Do not use hot steam on cold glass surfaces; this will cause glass to break.
3. Do not use the SF-275 SteamMax Cleaner to clean soft plastics.
4. Always test a small area when using the unit to clean carpets, draperies, upholstery, or other fabric surfaces.
5. Your steam cleaner will remove wallpaper and self-adhesive vinyl. Do not use the unit on these types of surfaces unless you wish to achieve this result.

Product Specifications

Unit Weight--Dry	10 lbs.
Unit Weight—Full Water Tank	13.1 lbs.
Water Tank Capacity	50 oz.
Input Voltage	120 volts
Input Frequency	60 hertz
Output Power	1500 watts
Current Rating	12.5 amps

Model SF-275 SteamMax Cleaner: Product Information

Your SF-275 SteamMax Cleaner package includes the following features and accessories:

- SteamMax Cleaner (A)
- Lift Handle (B)
- Hose (C) with Attached Handle (D)
- Steam Lock Button (E)
- Steam Control Switch (F)
- Steam Jet Nozzle (G)
- Terry Cloth Towel for Large Brush (H)
- Upholstery/Floor Brush (I)
- Triangle Brush (J)
- Measuring Cup (K); Funnel (L)
- 1 Utility Brush (M)
- Squeegee (N)
- Steam Ready Light (O)
- 2 Extension Wands (P)

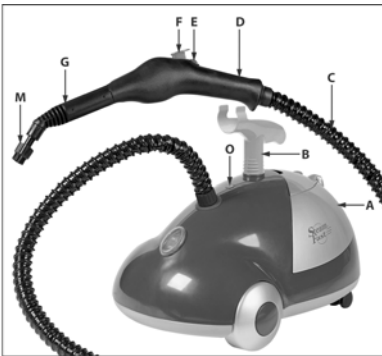

Using Your SF-275 SteamMax Cleaner

Important: To insure proper use and to avoid potential bodily injury or damage to the unit, read all instructions carefully prior to using your SF-275 SteamMax Cleaner.

The SF-275 SteamMax Cleaner is only meant to be used with recommended SF-275 accessories. Other types of attachments such as those used with vacuum cleaners are not to be used with the SteamMax Cleaner. Doing so may cause injuries or damage to the unit.

Your SF-275 SteamMax Cleaner comes with a number of convenient attachments:

- **Extension Wands** Access hard-to-reach areas such as ceiling fixtures, draperies, and vents. Use wands and the floor brush to clean floors.
- **Steam-Jet Nozzle** Provides concentrated jet of steam for tough cleaning tasks.
- **Utility Brush** Attaches to the steam jet nozzle. Use when cleaning ceramic, metal, plastic, and fiberglass surfaces. Use to remove stains from carpets. This will be your most useful attachment.
- **Squeegee** Clean patio doors, mirrors, windows, and other glass surfaces.
- **Large Brush** Cleans and removes odors from carpets, draperies, upholstery, and floor surfaces.
- **Terry Cloth Towel** Safely cleans sealed hardwood and tile floors.
- **Triangle Brush** Easily cleans hard-to-reach places.
- **Lift Handle** Attaches to the top of the unit. Serves as both a means of carrying the unit and as a place to set the steam nozzle when not in use.

Optional Attachments:

- **Scrub Pad** Newly designed to assist you in cleaning kitchen counters, sinks, and more.
- **BBQ Grill Brush** Use to remove grease and grime from outdoor grills.

Assembling Attachments



Attachments will become hot while unit is in use. Allow nozzle to cool completely before attempting to change attachments.

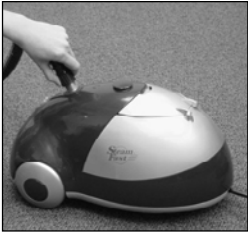

1. Screw hose onto threaded valve on unit by turning clockwise until hose is firmly tightened.

2. Prior to filling and using your SF-275 SteamMax Cleaner, select and install the appropriate attachment. To install a cleaning attachment, depress the lock/release button located on the handle and slide the attachment into position so that the rectangular hole in the tool slides over the lock/release button. When the attachment is properly installed, the lock/release button will click into position.



3. To disconnect an attachment, depress the lock-release button on the handle, and slide the attachment over the button.
4. When attaching the utility brush, align the groove on the steam jet nozzle with the raised nub of the utility brush attachment.

Filling the Water Reservoir



Warning: In order to avoid bodily injury or damage to the unit when using the SF-275 SteamMax Cleaner, allow the unit to cool for a minimum of (5) minutes before refilling with cold water. Before refilling the unit, unplug the power cord. Do not overfill the water reservoir (See the instruction table on the next page). Before refilling the unit, drain any water that may be left over from previous use to avoid overfilling of the reservoir. Do not add detergents or any other type of chemicals or cleaning compounds to the water reservoir.

Amount of Water vs. Approximate Steam Duration

16 oz. of water	Approx. 15 min.
32 oz. of water	Approx. 35 min.
48 oz. of water	Approx. 50 min.



1. Turn switch off; Push steam control switch on the handle to release steam before unscrewing the cap. Remove the reservoir cap by rotating it counter-clockwise until the cap can be removed.
2. Fill the provided SteamMax measuring cup with water. Use distilled or de-mineralized water in areas where tap water contains high mineral concentrations.



3. Using the provided SteamMax funnel, pour the contents of the measuring cup into the water reservoir fill hole. **Do not overfill the reservoir. Do not use any type of detergent, chemical, or other cleaning agent in your SteamMax Cleaner. The unit can hold a maximum of 3 measuring cups full of water.**
4. Replace the reservoir cap. Tighten the reservoir cap by placing the threaded portion of the cap into the reservoir fill hole, and turning the cap clockwise until snug. Do not over-tighten. This will ensure that the reservoir and cap are sealed securely.



Warning: Failure to properly close the cap can allow hot, pressurized steam to escape from the reservoir, causing bodily injury.

5. The On/Off Switch is located on the top of the unit. After properly filling the water reservoir, plug the unit into a three-pronged outlet. Turn switch to "On" position; switch will be lighted any time the unit is plugged in and set on the "On" position.
6. Your SteamMax Cleaner will be ready to use in 2-8 minutes, depending on how much water is in the reservoir tank. The steam ready light will be on while the unit is heating. When the steam ready light is no longer lit, you are ready to utilize the power of steam. The unit is designed to self-regulate the temperature and pressure of the steam in the water reservoir. If you do not use your SteamMax unit for a period of time (approximately 4-7 minutes), the unit will discontinue heating in order to regulate steam pressure, and the steam ready light will appear again. After reheating, the steam ready light will once again disappear when the unit has reached the desired temperature and pressure.



7. Push down on the steam control button on the top of the handle for a burst of steam. For constant steam, slide steam control forward while the steam button is depressed.
8. To clean, simply direct the hose at the dirt and grime you wish to remove. Using a slight back-and-forth motion will enhance the cleaning process when dealing with tough dirt, grease, and grime.
9. Wipe the steamed area with a clean cloth to remove loosened dirt and grime. Wiping the area while it is still wet is recommended, but take great care when wiping surfaces such as metal that may still be hot.



Care and Storage Guidelines

1. Preparing your SteamMax Cleaner for storage is quick and simple. When you have finished your cleaning tasks, turn the power switch to the "Off" position. Unplug the power cord, and allow the unit to cool completely. After the unit has cooled, dump any remaining water in the water reservoir into a sink or tub to prevent overflowing during your next use and to minimize potential mineral buildup in the water reservoir.
2. Store small accessories neatly into the accessory compartment.



3. Store the unit indoors in a cool, dry area.

Removing Mineral Build-Up

One common problem with steam appliances is mineral build-up caused by the high mineral content in many municipal water supplies.

The best way to avoid this is to use de-mineralized or distilled water in the unit.

If you are unable to use de-mineralized or distilled water, we recommend you use this procedure monthly to help avoid mineral build-up.

1. Turn unit off, and unplug the power cord.
2. Drain the water reservoir.
3. Remove the hose from the unit.
4. Using the measuring cup, make a mixture of one cup (8oz.) of vinegar and one cup (8oz.) of water.
5. Slowly pour the water-vinegar solution into the water reservoir, using the funnel.
6. Allow to stand for 40 minutes.
7. Drain the water-vinegar solution from the water reservoir.
8. Rinse the water reservoir with fresh water and drain until the vinegar odor dissipates.
9. Replace cap.

The following tips are provided for your assistance with common, easily-solved problems.

Problem	Possible Cause	Solution
Unit fails to heat	<p>Check to ensure unit is plugged in.</p> <p>Be sure power switch is in the “On” position.</p>	<p>Push plug securely into outlet. Try another outlet.</p> <p>Check circuit breaker. Check with qualified electrician.</p>
Excess water shoots from steam jet nozzle	<p>Water has condensed in the wand and/or hose.</p> <p>Water reservoir has been overfilled.</p> <p>Unit has not reached operating temperature.</p>	<p>This is normal if the unit sits unused for a period of time, as condensation may develop in the hose. Point trigger at a tub, sink, or towel. Continue to push the trigger down until excess water is released.</p> <p>Press steam delivery button to discharge any water that has condensed in wand or hose into a bucket, tub, or sink.</p> <p>Wait for Steam Ready Light to turn on.</p>
Water spits out from fill spout when adding additional water.	<p>The water reservoir is too hot to be refilled.</p>	<p>Allow more cooling time before refilling.</p> <p>Fill water reservoir more slowly. Be sure to use the provided funnel and measuring cup to refill unit.</p>

<p>Accessories do not stay firmly attached to handle.</p>	<p>Attachments are not installed properly.</p>	<p>Review steps for proper installation of attachments.</p> <p>Check to ensure that attachments are installed correctly. Align the groove with the section of attachment.</p>
<p>Unit heats up, but there is no steam output.</p>	<p>The water tank is empty.</p> <p>The nozzle or hose is blocked.</p>	<p>Turn the unit off, and allow to cool. Refill the water tank as instructed.</p> <p>Discontinue using the unit, and place a service call for further instructions.</p>

Customer Support

Contact our Customer Support Team at Top Innovations, Inc. at 1-816-584-9700 ext. 102/130, e-mail us at customerservice@topinnovations.com or visit our web site at www.topinnovations.com

To enable us to better assist you, please have Model and Serial numbers on hand when contacting our Customer Support Team.

NOTE: THIS UNIT IS NOT FOR DISINFECTING!

Always use your steam cleaner as a first approach to cleaning any stain; in most instances, this approach is all that will be needed to remove stains and soiling. The tips below have been compiled from a variety of sources in order to assist you in the removal of stains and soiling that may remain after your first approach to removal; however, they are not a guarantee that all stains can be effectively treated by using any of the suggested approaches. When attempting to treat any stained or soiled area, be sure to test the selected method of cleaning on a small, inconspicuous area to ensure colorfastness, etc. **Top Innovations, Inc. is not responsible for any damages to any surface, fabric, or fiber as a result of attempted stain removal.** Do not use more than one type of chemical or detergent cleaning agent to remove a stain. To remove stains treated with baking soda, only use water or steam.

- When possible, treat spills as soon as possible after they occur. Using a clean, white absorbent towel, blot as much of the spilled liquid up as possible. In order to avoid imbedding the stain into the affected area, do not rub. Extract as much liquid as possible before treating the area with your SteamMax Cleaner.
- After blotting most of the spilled liquid from the affected area, begin the steam cleaning process.
- **Always treat the affected area with the SteamMax Cleaner before attempting to use any other type of cleaning agent. The goal is to eliminate the stain while reducing the need to use detergent or chemical solutions that can damage surfaces, fabrics, and fibers. Whenever possible, avoid using cleaning solutions or agents to remove stains.**
- Acidic or caustic spills should be quickly flushed with water. Next, sprinkle a neutralizing agent such as baking soda or an ammonia solution onto the affected area. Do not vacuum any area that has been stained or soiled by an acidic liquid or allow it to dry before it has been neutralized.

Always use your steam cleaner as a first approach to cleaning any stain; in most instances, this approach is all that will be needed to remove stains and soiling. The tips below have been compiled from a variety of sources in order to assist you in the removal of stains and soiling that may remain after your first approach to removal; however, they are not a guarantee that all stains can be effectively treated by using any of the suggested approaches. When attempting to treat any stain or soiled area, be sure to test the selected method of cleaning on a small, inconspicuous area to ensure colorfastness, etc. **Top Innovations, Inc. is not responsible for any damages to any surface, fabric, or fiber as a result of attempted stain removal.** Do not use more than one type of chemical or detergent cleaning agent to remove a stain. To remove stains treated with baking soda, only use water or steam.

Stain Type	Best Approach	Cleaning Agents
Foods	Do not allow to dry.	Enzyme Detergent
Egg	Do not use hot water or steam.	Enzyme Detergent
Syrups	Do not allow to set.	Laundry Pre-Treating Agent
Mustard	Do not allow to set.	Diluted Vinegar Solution
Chocolate	Do not allow to dry.	Diluted Ammonia Solution
Alcoholic Beverages	Do not allow to dry.	Diluted Vinegar Solution
Carbonated Beverages	Do not allow to dry.	Diluted Ammonia Solution
Fruit Juices	Avoid oil-based detergents.	Diluted Vinegar Solution
Coffee or Tea	Do not allow to set.	Laundry Pre-Treating Agent
Milk/Dairy Products	Do not allow to set.	Diluted Vinegar Solution
Grease and Oil	Do not rub stain.	Enzyme Detergent
Mud and Dirt	Allow to dry, then vacuum.	Steam Clean

Top Innovations, Inc. warrants this product to be free from defects in material and workmanship for a period of one (1) year from the date of purchase. This warranty does not cover damage caused by misuse, negligence, use by improper current or voltage, use contrary to operating instructions or disassembly, repair or alteration by any person other than Top Innovations, Inc. Warranty Service Department.

Top Innovations, Inc. will repair or replace, at its option. This warranty gives you specific legal rights and may have other rights, which may vary from state to state.

Performance of any obligation under this warranty may be obtained by:

1. Call (800) 711-6617 for Return Authorization Number before returning for repair
2. Include copy of purchase receipt
3. Include your name, address, telephone number, and Return Authorization Number on returned package

Please send product postage prepaid to:

TOP INNOVATIONS, INC.
WARRANTY SERVICE DEPARTMENT
400 NW PLATTE VALLEY DR.
RIVERSIDE, MO 64150

After 1 year limited warranty has expired, you will be advised of the cost of repair before any servicing is done unless you enclose a note indicating that you would like us to proceed with repairs.

If you have any questions about coverage under this warranty, you may contact warranty service department by telephone at (800) 711-6617 ext. 102 / 130, e-mail customerservice@topinnovations.com or visit our website at www.topinnovations.com

Attaching Lift Handle

1. Remove Lift Handle Cap from unit.
2. Insert Lift Handle into Intake Hole on top of unit. Please refer to illustration below for assistance with proper alignment.
3. Using enclosed magnetic screw driver and screw, securely fasten Lift Handle to unit (see illustration below).

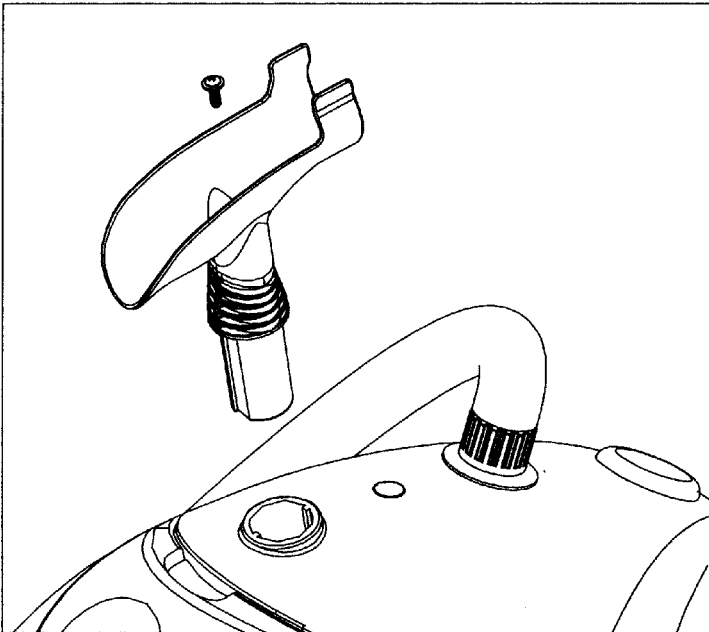



MODEL SF-260 / SF-275

ONLINE ORDERING
Try our secure and convenient online ordering system through our website: www.topinnovations.com

ACCESSORY ORDER FORM

PART	PART DESCRIPTION	PRICE (FOR 1)	PRICE (FOR 4)	QTY.	TOTAL
A275-001	Triangle Brush	\$3.99	\$11.96		
A275-002	10 mm Nylon Utility Brush	\$2.99	\$7.96		
A275-003	15 mm Nylon Utility Brush	\$2.99	\$7.96		
A275-004	Brass Utility Brush	\$3.99	\$11.96		
A275-005	Squeegee	\$12.99	N/A		
A275-006	Cloth Cover	\$2.99	\$7.99		
A275-007	Floor Brush	\$12.99	N/A		
A275-008	Extension Wand (2 pcs.)	\$8.99	N/A		
A275-010	Scrub Pad	\$2.99	\$7.99		
A275-C1	Special Value Pack #1 - A \$31.21 value for only \$19.99 Includes: - 5 10mm Utility Brushes - 4 15mm Utility Brushes - 1 Brass Utility Brush - 1 Scrub Pad				
A275-C2	Special Value Pack #2 - A \$32.94 value for only \$19.99 Includes: - 4 10mm Utility Brushes - 4 15mm Utility Brushes - 2 Cloth Covers - 2 Scrub Pads				
A275-C3	Special Value Pack #3 - A \$36.00 value for only \$24.99 Includes: - 1 Extension Wand (2 pcs.) - 1 Squeegee - 1 Floor Brush			SUBTOTAL	
				+ SHIPPING AND HANDLING	\$3.99
				TOTAL USD	

METHOD OF PAYMENT (no C.O.D. orders)

Check or Money Order (payable to Top Innovations)

Charge to my: VISA MASTERCARD

--	--	--	--	--	--	--	--	--	--	--	--	--	--	--	--	--	--	--	--	--

ACCOUNT NUMBER

--	--	--	--

EXPIRATION DATE

SIGNATURE: _____

(Full Name as Shown on Account)

NAME: _____

MAILING ADDRESS: _____

TELEPHONE: _____

<p>TO ORDER:</p> <p>ONLINE Visit www.topinnovations.com</p> <p>BY MAIL Fill out this form and return to: Top Innovations, Inc. 400 NW Platte Valley Dr. Riverside, MO 64150</p> <p>BY PHONE (800) 711-6617 EXT. #102 / 130</p> <p>BY FAX (816) 584-9066</p>
--

STEAMMAX™

CLEANER

Printed in China

Top Innovations, Inc.
400 NW Platte Valley Drive, Riverside, MO 64150
1-800-711-6617 Tel: 816-584-9700 Fax: 816-584-9066
www.topinnovations.com